

N/F DEUSO, MICHAEL J. & MARY H.

TOWN OF MONTGOMERY

N/F PHILLIPS, MARSHA

SCALE 1" = 20'-0"
20 0 20

REV	DESCRIPTION	DATE

FILENAME	DESIGNED	DRAWN	CHECKED	DATE
2212980100bdr.lay	NLC	ZAR	XXX	JULY 2023
MODEL NAME	LAY 01B			
SCALE	AS SHOWN			

HOYLE TANNER

125 College Street, 4th Floor • Burlington, VT 05401
(802) 860-1331 • www.hoyletanner.com

TOWN OF MONTGOMERY
MONTGOMERY CENTER STREETSCAPE
MONTGOMERY CENTER STREETSCAPE
ALT 2 - LAYOUT SHEET (1 OF 7)

8/25/2023 1:51:36 PM V:\1_PROJECTS\Montgomery-VT22_128801_00-Montgomery-Center-Streetscape2-CADD\CutSheets\2212980100bdr.lay.dgn

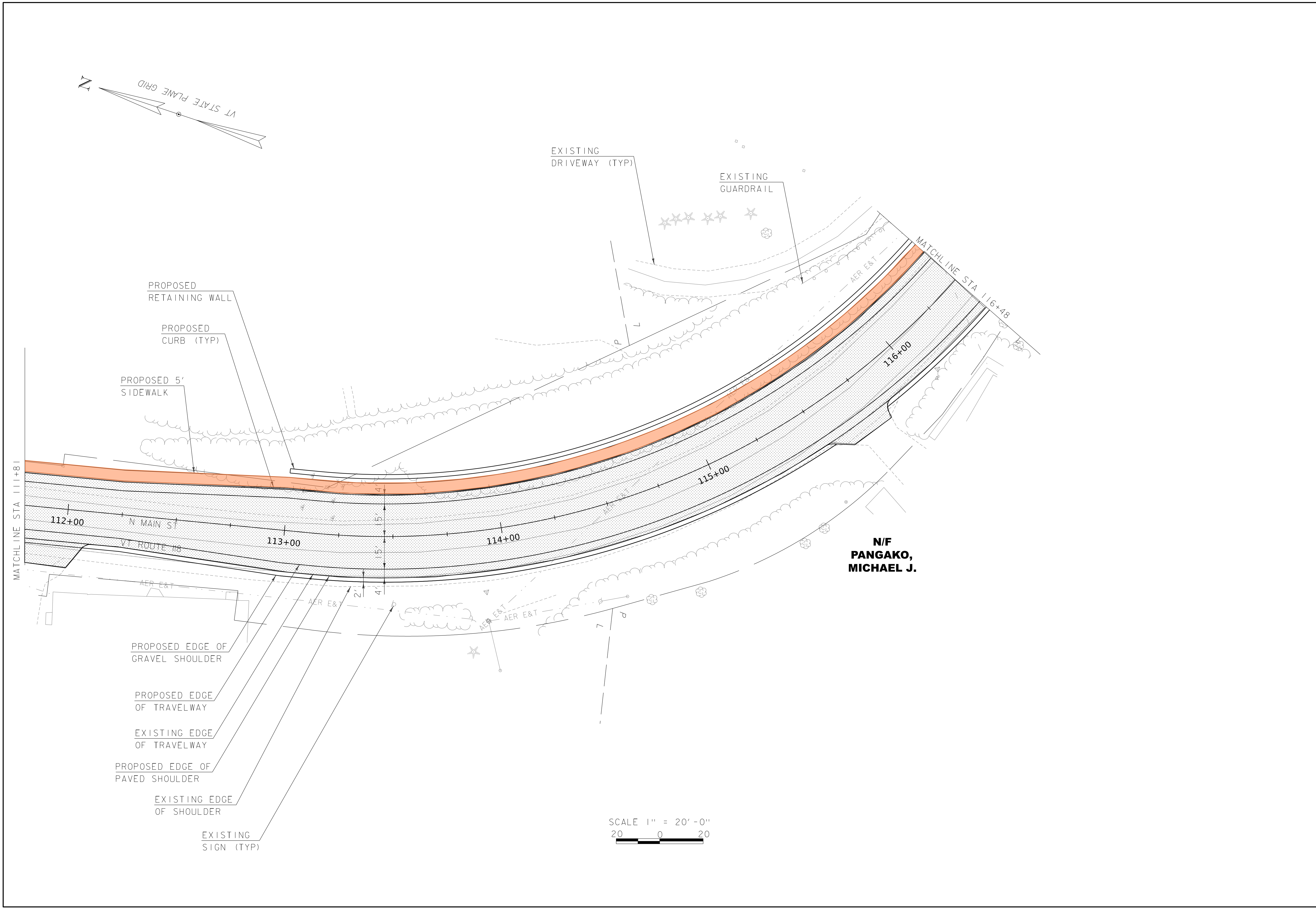

REV	DESCRIPTION	DATE

VAOT BRIDGE NO.	N/A
FILENAME	2212980100bdr_Lay
DESIGNED	NLC
DRAWN	ZAR
CHECKED	XXX
AS SHOWN	XXX
DATE	JULY 2023

HOYLE TANNER

125 College Street, 4th Floor • Burlington, VT 05401
(802) 860-1331 • www.foyletanner.com

TOWN OF MONTGOMERY
MONTGOMERY, VERMONT
MONTGOMERY CENTER STREETSCAPE

ALT 2 - LAYOUT SHEET (2 OF 7)

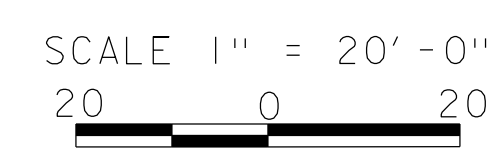
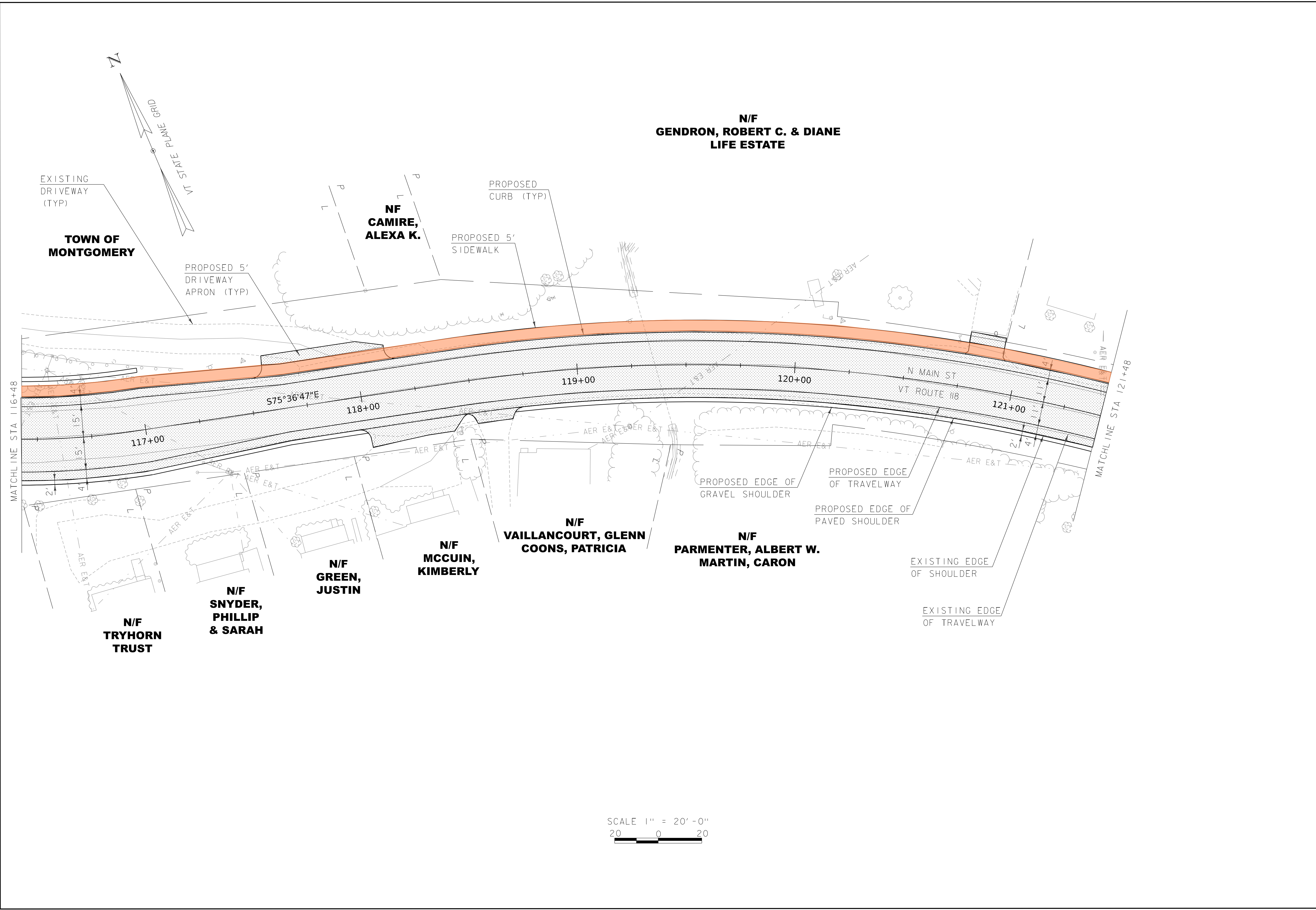

REV	DESCRIPTION	DATE	BY	CHECKED

VAOT BRIDGE NO.	N/A
FILENAME	2212980100bdr_Lay
DESIGNED	NLC
MODEL NAME	ZAR
LAY O3B	ZAR
CHECKED	XXX
AS SHOWN	XXX
DATE	JULY 2023

<p>HOYLE TANNER</p> <p>125 College Street, 4th Floor • Burlington, VT 05401 (802) 860-1331 • www.foyletanner.com</p>	
<p>TOWN OF MONTGOMERY MONTGOMERY, VERMONT</p>	<p>MONTGOMERY CENTER STREETSCAPE</p>
<p>ALT 2 - LAYOUT SHEET (3 OF 7)</p>	
<p>PROJECT NO. 22.129801.00</p>	
<p>SHEET NO.</p> <p style="text-align: center; font-size: 2em; font-weight: bold;">3</p>	
<p>SHEET 3 OF 7</p>	

This document is prepared as an instrument of service and shall remain the property of Hoyle, Tanner. It may not be used, reproduced, disseminated or transferred in any manner, including electronically, for any other purpose than this project, without the written permission of Hoyle, Tanner.

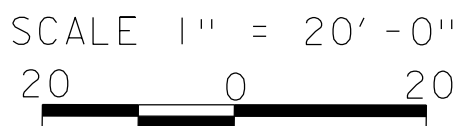
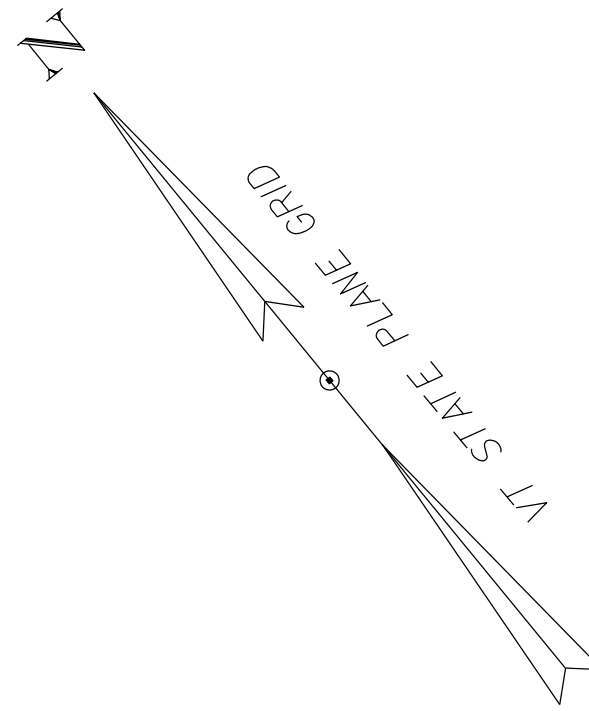
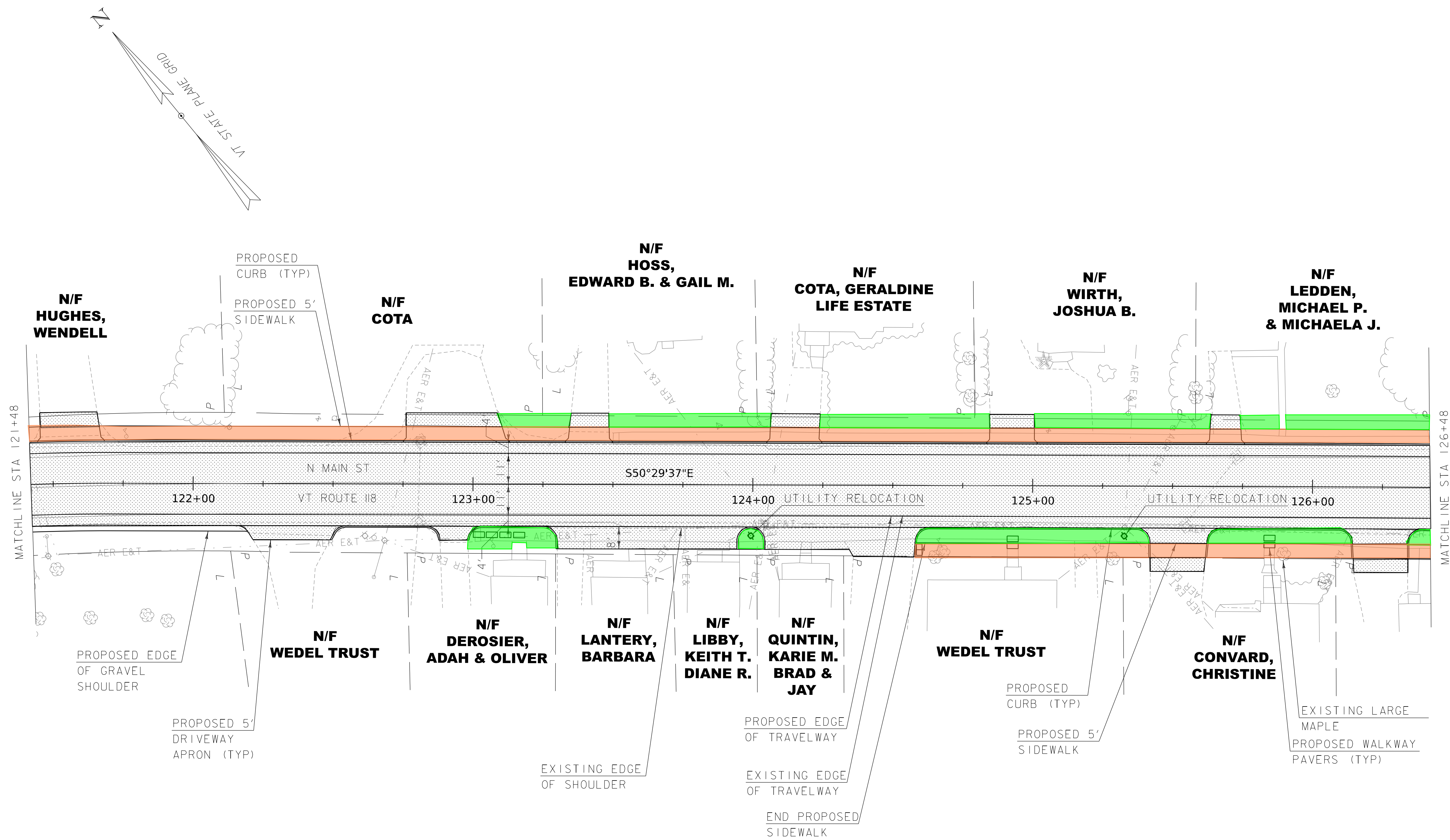

REV	DESCRIPTION	DATE

VAOT BRIDGE NO.	N/A
FILENAME	2212980100bdr_Lay
DESIGNED	NLC
DRAWN	ZAR
CHECKED	XXX
AS SHOWN	XXX
DATE	JULY 2023

HOYLE TANNER

125 College Street, 4th Floor • Burlington, VT 05401
(802) 860-1331 • www.foyletanner.com

TOWN OF MONTGOMERY
MONTGOMERY, VERMONT
MONTGOMERY CENTER STREETSCAPE

ALT 2 - LAYOUT SHEET (4 OF 7)

This document is prepared as an instrument of service and shall remain the property of Hoyle, Tanner. It may not be used, reproduced, disseminated or transferred in any manner, including electronically, for any other purpose than this project, without the written permission of Hoyle, Tanner.

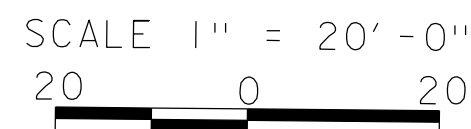
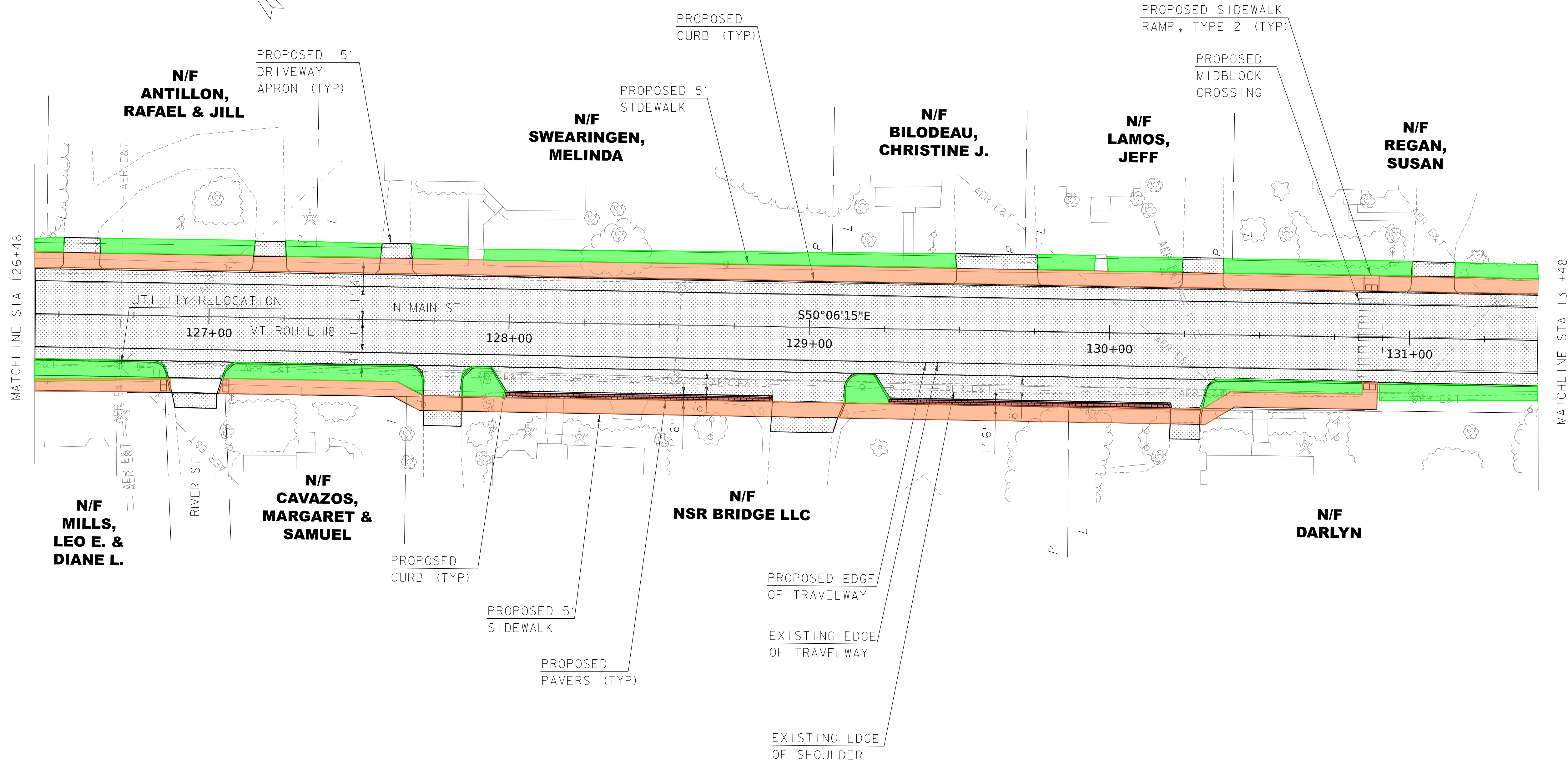
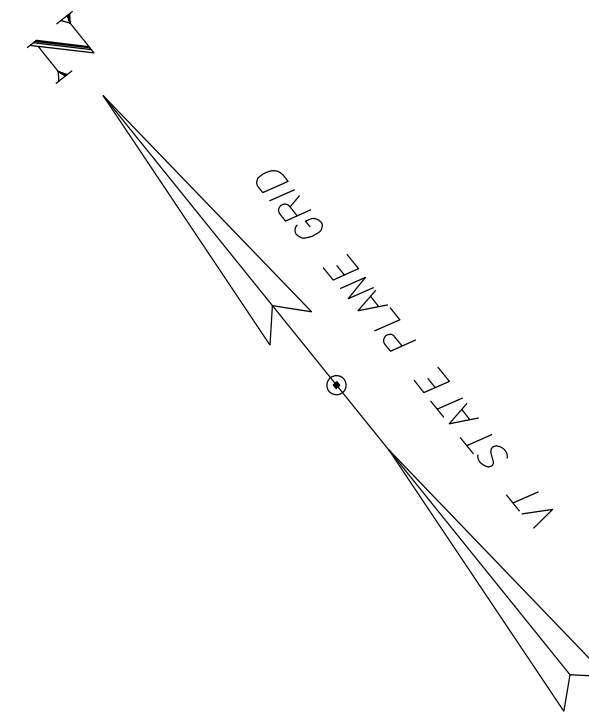

REV	DESCRIPTION	DATE

DESIGNED BY	
CHECKED BY	
DRAWN BY	
SCALE	
AS SHOWN	
DATE	JULY 2023

HOYLE TANNER

125 College Street, 4th Floor • Burlington, VT 05401
(802) 860-1331 • www.foyletanner.com

TOWN OF MONTGOMERY
MONTGOMERY, VERMONT
MONTGOMERY CENTER STREETSCAPE
ALT 2 - LAYOUT SHEET (5 OF 7)

This document is prepared as an instrument of service and shall remain the property of Hoyle, Tanner. It may not be used, reproduced, disseminated or transferred in any manner, including electronically, for any other purpose than this project, without the written permission of Hoyle, Tanner.

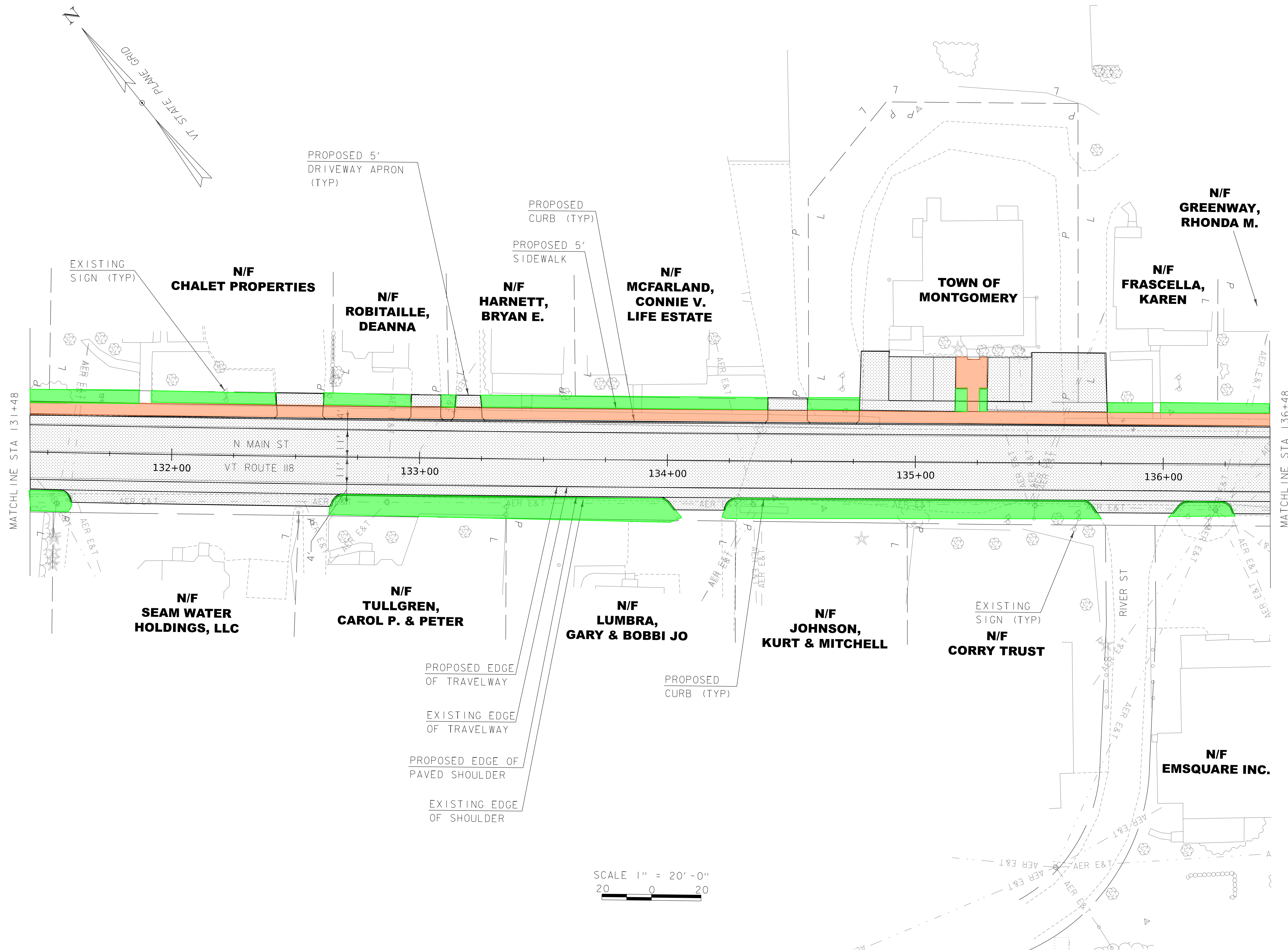

REV	DESCRIPTION	DATE

FILENAME	DESIGNED	NLC	DRAWN	CHECKED	DATE
2212980100bdr_Lay					
MODEL NAME	LAY 06B	ZAR	XXX	XXX	

This document is prepared as an instrument of service and shall remain the property of Hoyle, Tanner. It may not be used, reproduced, disseminated or transferred in any manner, including electronically, for any other purpose than this project, without the written permission of Hoyle, Tanner.

HOYLE TANNER
125 College Street, 4th Floor • Burlington, VT 05401
(802) 860-1331 • www.hoyletanner.com

TOWN OF MONTGOMERY
MONTGOMERY, VERMONT
MONTGOMERY CENTER STREETSCAPE
ALT 2 - LAYOUT SHEET (6 OF 7)

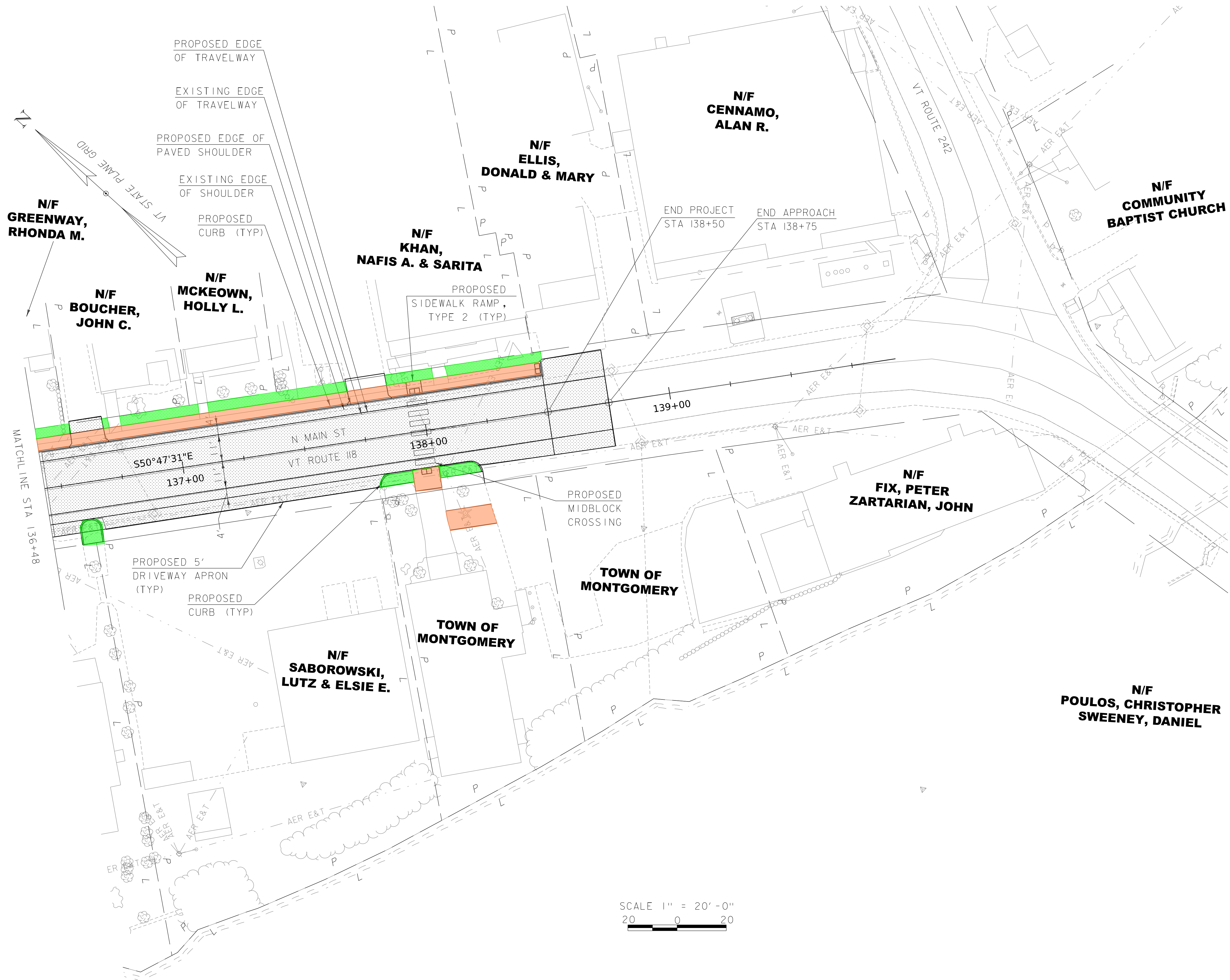

REV	DESCRIPTION	DATE

FILE NAME	DESIGNED	NLC	DRAWN	CHECKED	DATE
2212980100bdr_Lay					
MODEL NAME	LAY 07B	ZAR			
SCALE	AS SHOWN	XXX			

This document is prepared as an instrument of service and shall remain the property of Hoyle, Tanner. It may not be used, reproduced, disseminated or transferred in any manner, including electronically, for any other purpose than this project, without the written permission of Hoyle, Tanner.

HOYLE TANNER

 125 College Street, 4th Floor • Burlington, VT 05401
 (802) 860-1331 • www.hoyletanner.com

TOWN OF MONTGOMERY
 MONTGOMERY, VERMONT
 MONTGOMERY CENTER STREETSCAPE
 ALT 2 - LAYOUT SHEET (7 OF 7)